

AccuTemp[®]
INNOVATIVE COOKING EQUIPMENT SOLUTIONS

ACCUSTEAM[™]
HIGH PRODUCTION GRIDDLE

EGD G2 DROP-IN GRIDDLE PARTS MANUAL



This Manual is for EGD Drop-In Griddles Starting with Serial Number 24492 & Higher

ACCUTEMP PRODUCTS INC
11919 John Adams Dr. New Haven, IN 46774
www.accutemp.net Email: parts@accutemp.net
1-800-480-0415

 **WARNING**

The State of California enacted the California Safe Drinking Water and Toxic Enforcement Act of 1986, (Prop. 65), which “prohibits any person in the course of doing business from knowingly and intentionally exposing any individual to a chemical known to the State of California to cause cancer or reproductive toxicity without first giving clear and reasonable warning to such individuals.”

The Governor’s Scientific Advisory Panel added Carbon Monoxide to the list of hazardous chemicals known to cause reproductive harm.

In order to establish full compliance with Proposition 65, a yellow warning label has been attached to each gas fired unit manufactured by AccuTemp Products, Inc. Carbon monoxide would not be present in concentrations that would pose a “significant risk” to the consumer when the equipment is installed, operated and maintained as follows:

1. Installed in accordance with all local codes, or in the absence of local codes, with the current National Fuel Gas Code Z223.1, latest addenda.
2. Installed under a properly designed and operating exhaust hood.
3. Connected to the type of gas for which the unit is equipped.
4. Proper appliance pressure regulator installed on the gas supply line and adjusted for the manifold pressure marked on the rating plate.
5. Adequate air supply to the unit and adequate clearance around the flue.
6. The equipment is operated in the manner intended using the proper utensil for that type of appliance.
7. Keep the equipment clean and have it checked periodically.
8. Burner air adjustments, mechanical maintenance and repairs should be performed by qualified service personnel.

WARNING SYMBOL DEFINITIONS

SYMBOL DEFINITIONS

Symbols are used to attract your attention to possible dangers. They are only effective if the operator uses proper accident prevention measures. Some of the symbols are boxed text; while others maybe just picture icons. Please give this information the respect they deserve for safe operation.

Symbol Icons

Below are definitions of the symbol icons used in this manual.



DANGER

Indicates an imminently hazardous situation; which, if unchanged, will result in death or serious injury.



CAUTION

Indicates a potentially hazardous situation; which, if unchanged, will result in minor or moderate injury.

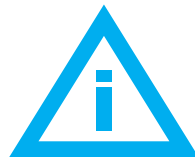

NOTE

Advises the reader of information or instructions, vital to the operation or maintenance of the equipment.



CAUTION - HOT SURFACE



DANGEROUS VOLTAGE

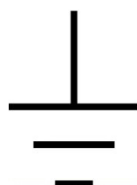

EARTH GROUND

SAFETY PRECAUTIONS



ELECTRICAL SHOCK HAZARD WHILE WORKING ON ENERGIZED EQUIPMENT.

Unplug equipment prior to removing any components effected by electricity.

BURN HAZARD WHILE WORKING ON STEAM PRODUCING EQUIPMENT.

When accessing the cooking chamber, be sure to always stand back while slowly opening the door to allow the chamber to vent off the steam. Never reach into the cooking chamber before it has completely vented off the steam.

Never reach into the cooking chamber or handle hot items without wearing the proper heat protective gloves. Steam coming out of the holes on the right side of the cooking chamber is invisible and can cause severe burns.

Water inside the steam chamber, creating steam, has a temperature of 212°F and will cause burns if touched or spilled on the skin.

PERSONNEL INJURY HAZARD WHILE PICKING UP OR MOVING HEAVY EQUIPMENT.

Always use 2 people and proper lifting techniques when picking-up, moving, or inverting heavy equipment.

SLIP & FALL HAZARD WHILE WORKING ON WATER HOLDING EQUIPMENT.

Keep the floor in front of the equipment clean and dry. If spills occur, clean them up immediately to avoid potential injuries.

Table of Contents

GRIDDLE MODEL G2 EGD ELECTRIC

Fig: 1.1 Drop-In Griddle Components - Page 6

Fig: 1.2 Drop-In Griddle Components - Page 7

Fig: 1.3 Remote Control Box Assy & Carton - Page 8

Fig: 1.4 Chassis Components - Page 9

Fig: 1.5 Chassis Components - Page 10

Fig: 1.6 Front Panel Components - Page 11

Fig: 1.7 Electrical Components - Page 12

Fig: 1.8 Electrical Components - Page 13

Active Standard Model Numbers

EGD2083B3650-(B0, C0, L0, Q0, R0)

EGD2403B3650-(B0, C0, L0, Q0, R0)

EGD4803B3650-(B0, C0, L0, Q0, R0)

EGD2083B4850-(B0, C0, L0, Q0, R0)

EGD2403B4850-(B0, C0, L0, Q0, R0)

EGD4803B4850-(B0, C0, L0, Q0, R0)

EGD2083B3664-C0

Active Military Model Numbers

EGD4403B3656-00

EGD4403B4856-00

Fig 1.1 Drop-In Griddle Components

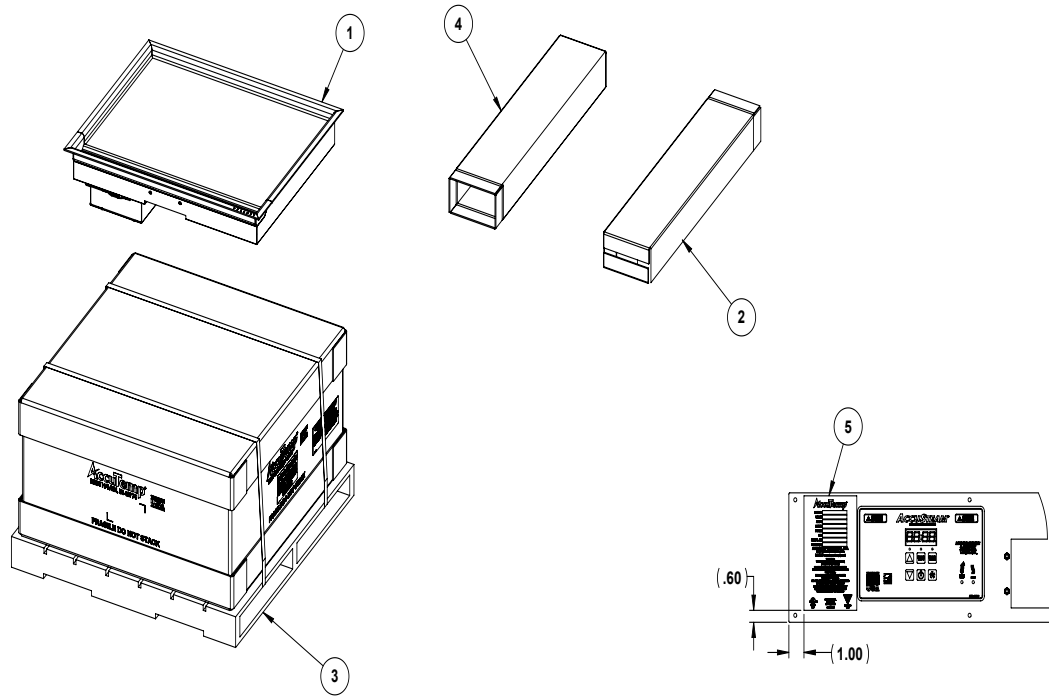

ITEM #	PART NUMBER	DESCRIPTION
#1-1	AT2A-6535-1	208V 36" DROP IN GRIDDLE
#1-2	AT2A-6535-2	208V 48" DROP IN GRIDDLE
#1-3	AT2A-6535-3	240V 36" DROP IN GRIDDLE
#1-4	AT2A-6535-4	240V 48" DROP IN GRIDDLE
#1-5	AT2A-6534-5	440V/480V 36" DROP IN GRIDDLE
#1-5	AT2A-6534-6	440V/480V 48" DROP IN GRIDDLE
#2-1	AT2A-6533-1	CONTROL PANEL ASSY - FULL
#2-2	AT2A-6533-2	CONTROL PANEL ASSY - RH
#2-3	AT2A-6533-3	CONTROL PANEL ASSY - LH
#3	AT2A-2771	SHIPPING PALLET
#4	AT2A-2772	LOOSE GRIDDLE PIECES
#5	AT2L-3725-1	DATA TAG, ELECTRIC GRIDDLE

Fig 1.2 Drop-In Griddle Components

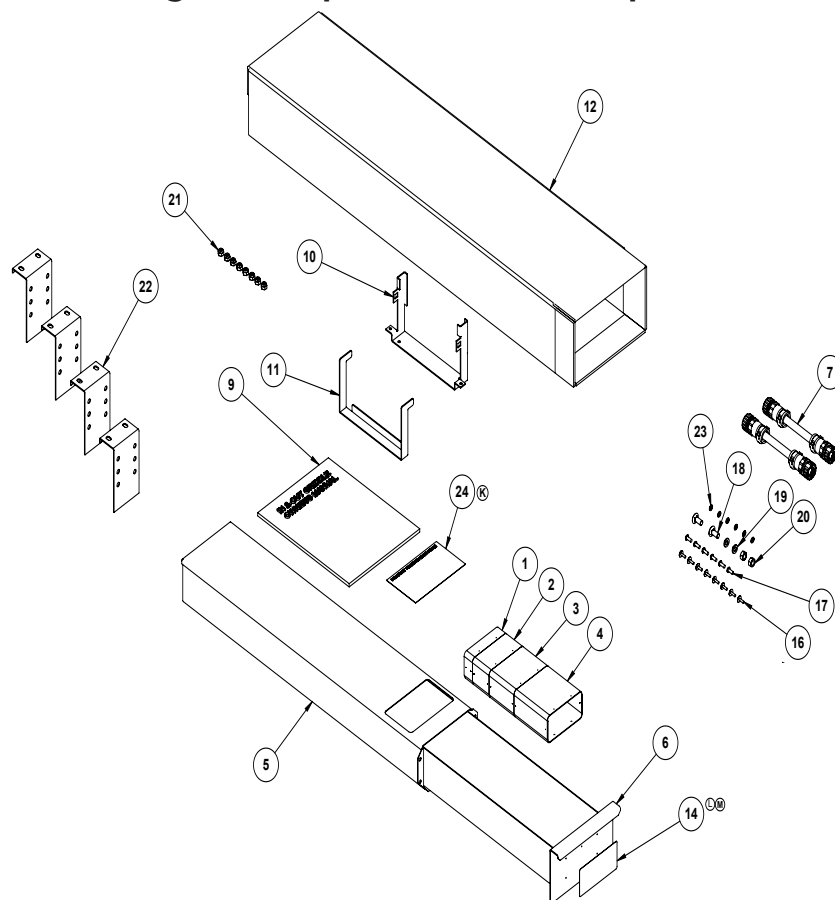

ITEM #	PART NUMBER	DESCRIPTION
#1	AT2A-2592-1	1" GREASE SPOUT EXTENSION
#2	AT2A-2592-2	2" GREASE SPOUT EXTENSION
#3	AT2A-2592-3	3" GREASE SPOUT EXTENSION
#4	AT2A-2592-4	4" GREASE SPOUT EXTENSION
#5	AT2A-2529-X	GREASE TROUGH ASSY*
#6	AT2A-2552-X	GREASE TRAY ASSEMBLY*
#7	AT2A-2764-X	CABLE ASSEMBLY*
#9	MP5004	ELECTRIC GRIDDLE OWNERS MANUAL
#10	AT2M-2553-1	GREASE TROUGH HNGR BRKT
#11	AT2M-2554-1	GREASE TROUGH HANGER
#12	AT2S-2726-1	RECTANGULAR TUBE
#14	AT0L-6466-1	OVERLAY, GREASE TRAY
#16	AT0F-2777-41040	SCREW, #10 TYPE AB X 1/2 TRUSS HD
#17	AT0F-2755-41040	SCREW, #10-24UNC X 1/2 PHILIPS ROUND HEAD
#18	AT0F-1921-61060	BOLT, 5/16-18 UNC 2A X 3/4" CARRIAGE
#19	AT0F-1922-60000	WASHER, 5/16" HELICAL SPRING LOCK
#20	AT0F-2778-61000	NUT, 5/16-18UNC-2B SS HEX MACHINE SCREW
#21	AT0F-2691-51002	NUT, 1/4-20 NYLOC
#22	AT2M-2535-1	RETAINER BRACKET
#23	AT0F-2666-40000	WASHER, SS #10 INTERNAL TOOTH LOCK
#24	AT0T-3033-1	PRODUCT REGISTRATION FORM
#25	AT2M-2554-2	GREASE TROUGH HANGER
#26	AT2M-5094-1	GREASE TROUGH HNGR BRKT

***CONTACT ACCUTEMP SERVICE PARTS AT 1-800-480-0415 OR EMAIL parts@accutemp.net**

Fig 1.3 Remote Control Box Assy & Carton

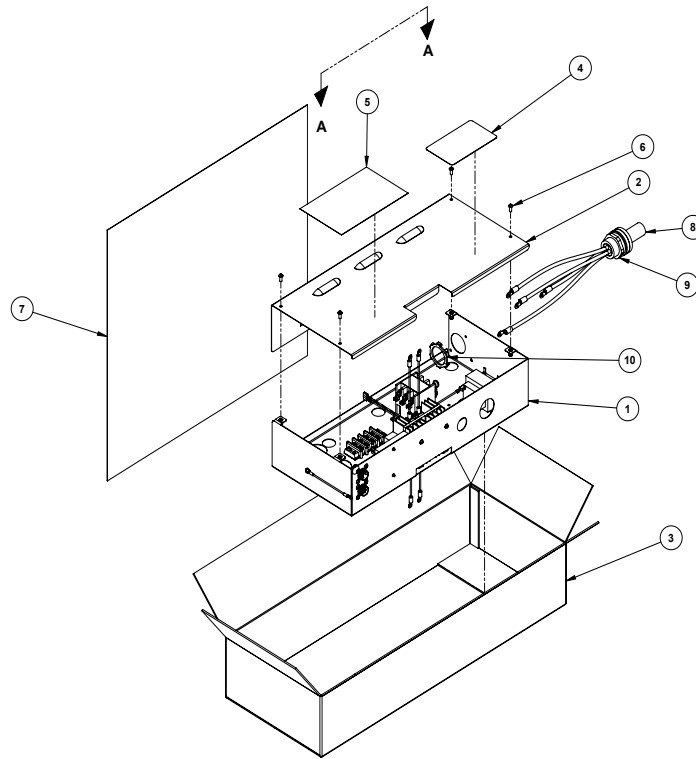

AT2A-6548-1

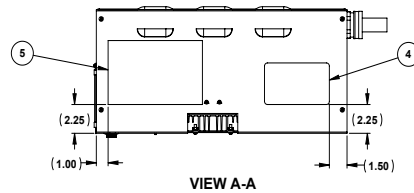

VIEW A-A

ITEM #	PART NUMBER	DESCRIPTION
#1	AT2A-6528-3	CONTROL BOX ASSEMBLY
#2	AT2M-6546-1	COVER, BOX, CONTROL
#3	AT2S-4882-3	CARTON, BOX 29.25 x 11.25 x 5.75
#4	AT0L-2798-1	OVERLAY, WARNING, ELECTRICAL
#5	AT2L-6418-1	SCHEMATIC LABEL, GRIDDL
#6	AT0F-2755-41040	SCREW, #10-24UNC X 1/2 PHILIPS ROUND HEAD
#7	AT0S-2935-2	PACKAGING, FOAM
#8	AT0A-2788-3	POWER CABLE ASSY
#9	AT0E-1049-1	STRAIN RELIEF 1 1/4" HUB CABLE RANGE
#10	AT0E-2086-4 1	CORD GRIP LOCKNUT

Fig 1.4 Chassis Components

Standard & Military Models Only

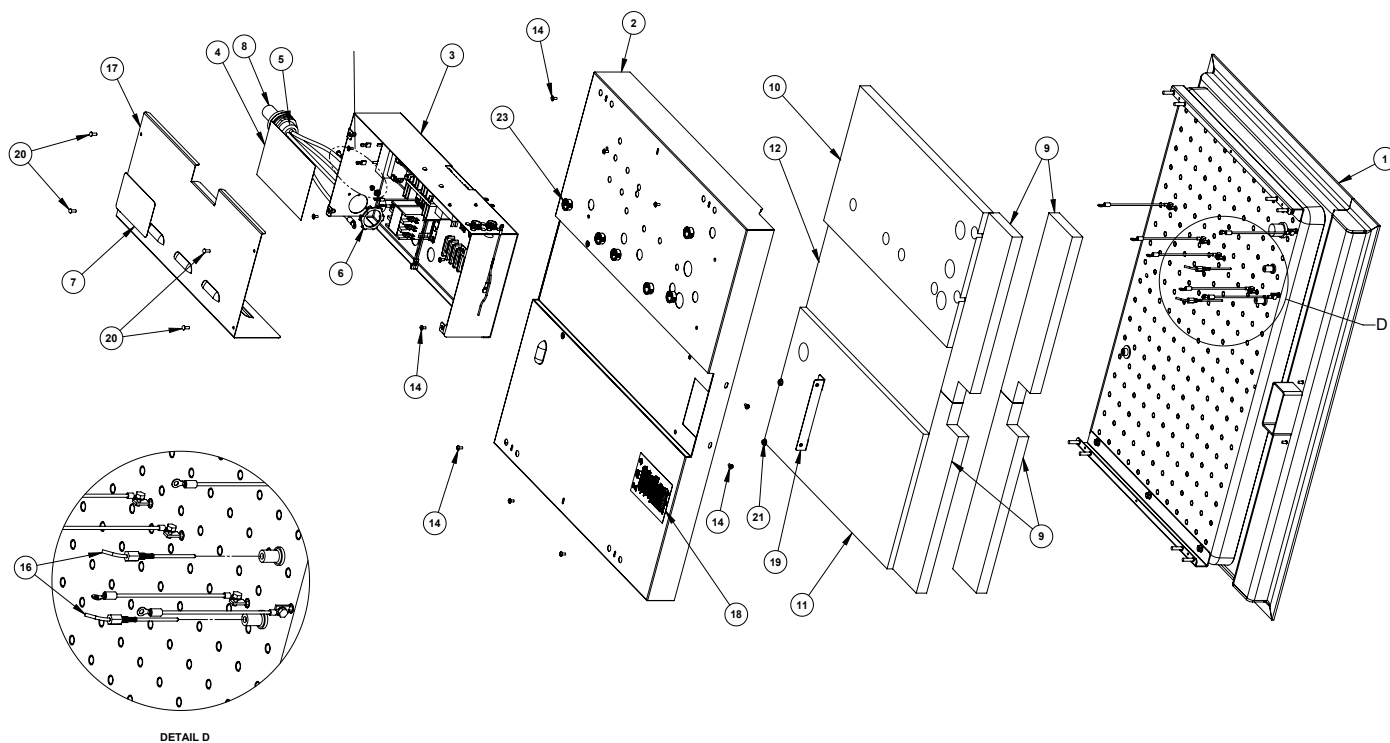

ITEM #	PART NUMBER	DESCRIPTION
#1	AT2A-6535-X	DROP IN CHAMBER ASSEMBLY*
#2	AT2A-6532-X	BOTTOM PAN ASSY*
#3	AT2A-6528-X	CONTROL BOX ASSEMBLY*
#4	AT2L-6418-X	SCHEMATIC LABEL, GRIDDLE*
#5	AT0E-1049-1	STRAIN RELIEF 1 1/4" HUB CABLE RANGE 1.00-1.125
#5-1	AT0E-1049-2	STRAIN RELIEF 3/4" HUB CABLE RANGE .625-.750
#6	AT0E-2086-X	CORD GRIP LOCKNUT*
#7	AT0L-2798-1	OVERLAY, WARNING, ELECTRICAL
#8	AT0A-2788-X	POWER CABLE ASSY*
#9	AT2I-6543-X	INSULATION*
#10	AT2I-6543-X	INSULATION*
#11	AT2I-6543-X	INSULATION*
#12	AT2I-6543-X	INSULATION*
#14	AT0F-1046-31030	SCREW, #8-32 x 3/8 PHLP TRUSS HEAD
#16	AT0E-5062-1	PROBE, SENSOR, RTD
#17	AT2M-6546-1	COVER, BOX, CONTROL
#18	AT2L-3725-1	DATA TAG, ELECTRIC GRIDDLE
#19	AT2M-5095-1	BRACE, SUPPORT
#20	AT0F-2755-41040	SCREW, #10-24UNC X 1/2 PHILIPS ROUND HEAD
#21	AT0F-1017-41002	NUT, #10-24UNC HEX SERRATED
#23	AT0H-2576-1	GROMMET, 7/8" NYLON

*CONTACT ACCUTEMP SERVICE PARTS AT 1-800-480-0415 OR EMAIL parts@accutemp.net

Fig 1.5 Chassis Components

EGD2083B3664-C0 Model Only

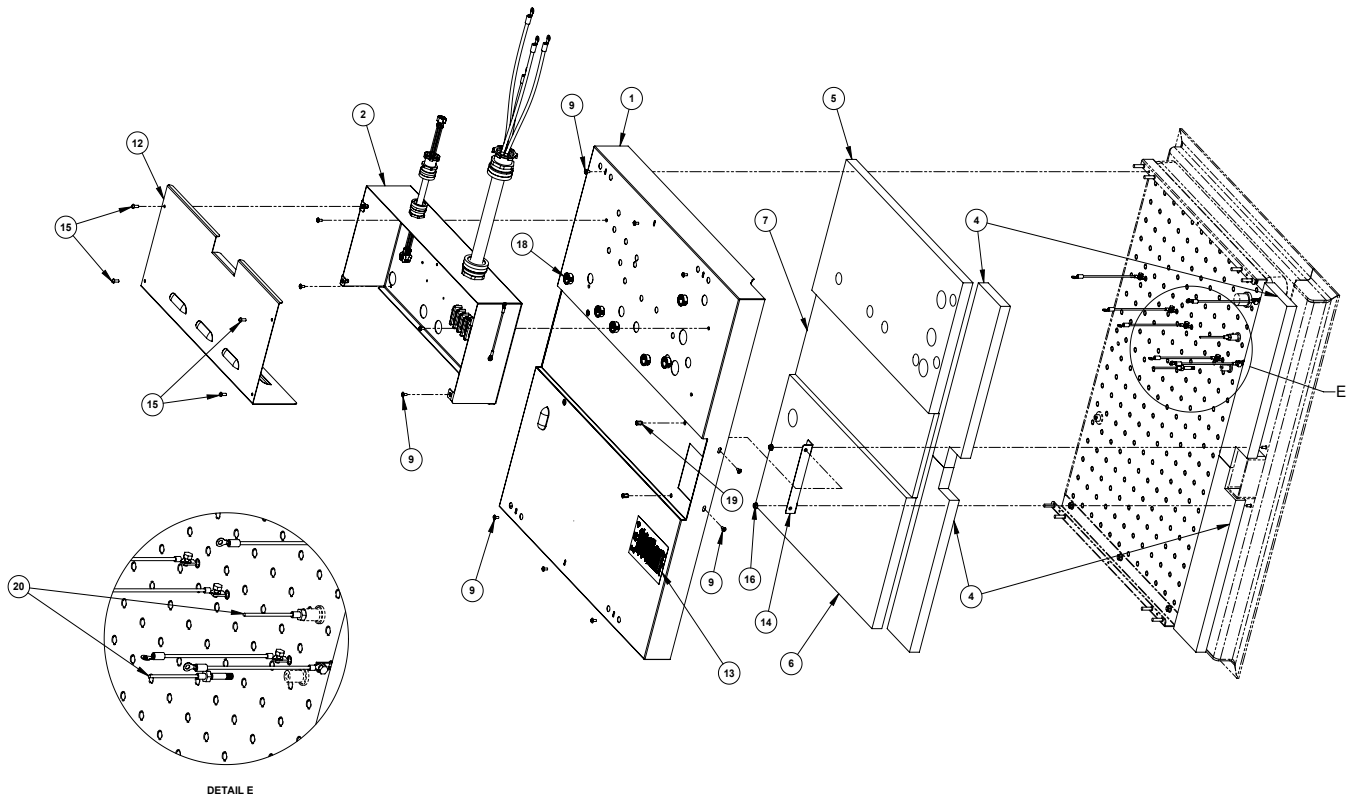

ITEM #	PART NUMBER	DESCRIPTION
#1	AT2A-6532-X	BOTTOM PAN ASSY*
#2	AT2A-6528-X	CONTROL BOX ASSEMBLY*
#3	AT0L-2798-1	OVERLAY, WARNING, ELECTRICAL
#4	AT2I-6543-1	INSULATION
#5	AT2I-6543-2	INSULATION
#6	AT2I-6543-4	INSULATION
#7	AT2I-6543-6	INSULATION
#8	AT2A-6527-19	HARNESS ASSEMBLY
#9	AT0F-1046-31030	SCREW, #8-32 x 3/8 PHLP TRUSS HEAD
#10	AT0F-2666-40000	WASHER, SS #10 INTERNAL TOOTH LOCK
#11	AT0E-5062-1	PROBE, SENSOR, RTD
#12	AT2M-6546-1	COVER, BOX, CONTROL
#13	AT2L-3725-1	DATA TAG, ELECTRIC GRIDDLE
#14	AT2M-5095-1	BRACE, SUPPORT
#15	AT0F-2755-41040	SCREW, #10-24UNC X 1/2 PHILIPS ROUND HEAD
#16	AT0F-1017-41002	NUT, #10-24UNC HEX SERRATED
#17	AT0E-2699-1	TERMINAL, QDISC, INSULATED FEM
#18	AT0H-2576-1	GROMMET, 7/8" NYLON
#19	AT0F-2668-1	NUTSERT, #10-24 HEX
#20	AT0E-2885-5	SENSOR, REPLACEABLE

*CONTACT ACCUTEMP SERVICE PARTS AT 1-800-480-0415 OR EMAIL parts@accutemp.net

Fig 1.6 Front Panel Components

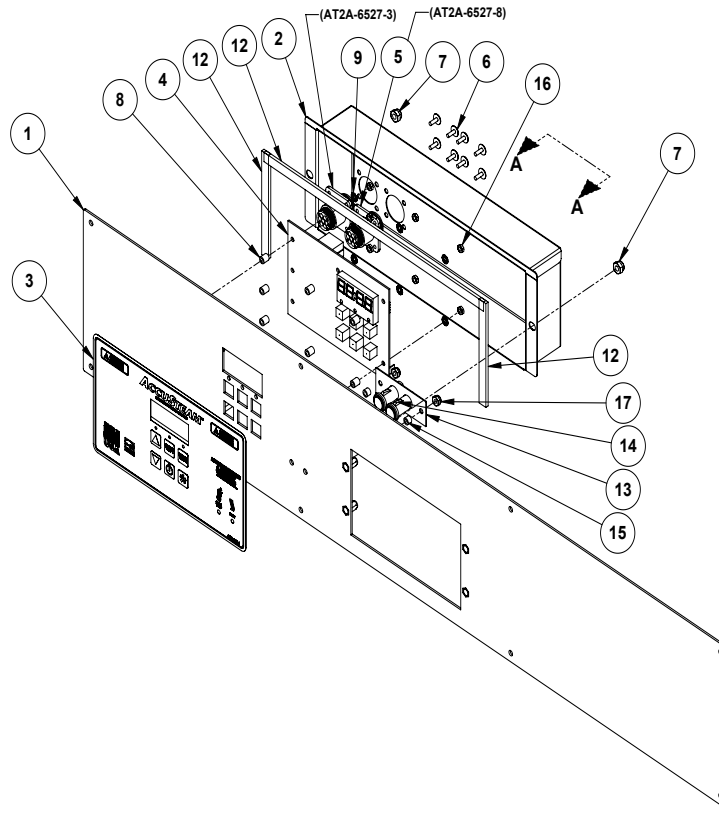

ITEM #	PART NUMBER	DESCRIPTION
#1	AT2A-6562-X	CONTROL PANEL SUBASSY*
#2	AT2M-6536-1	CONTROL PANEL COVER
#3	AT2L-6453-1	OVERLAY, CONTROL PANEL
#4	CONTACT ACCUTEMP	CONTROLLER, CIRCUIT BOARD*
#5	AT2A-6527-18	HARNES ASSEMBLY
#6	AT0F-2777-31030	SCREW, #8 TYPE AB X 3/8 TRUSS HD
#7	AT0F-2691-41002	NUT, #10-24 NYLOC
#8	AT0H-3623-1	SPACER, ROUND CLEAR HOLE
#9	AT0F-2666-21000	WASHER, SS #6 EXTERNAL TOOTH LOCK
#13	AT1M-3607-4	BRACKET, INDICATOR LAMP
#14	AT0E-1800-2	INDICATOR LAMP RED LED 28V
#15	AT0H-3623-2	SPACER, ROUND CLEAR HOLE
#16	AT0F-3621-1	NUT, #6-32UNC-2B UNDERSIZE
#17	AT0F-2691-21002	NUT, #6-32 NYLOC

*CONTACT ACCUTEMP SERVICE PARTS AT 1-800-480-0415 OR EMAIL parts@accutemp.net

Fig 1.7 Electrical Components

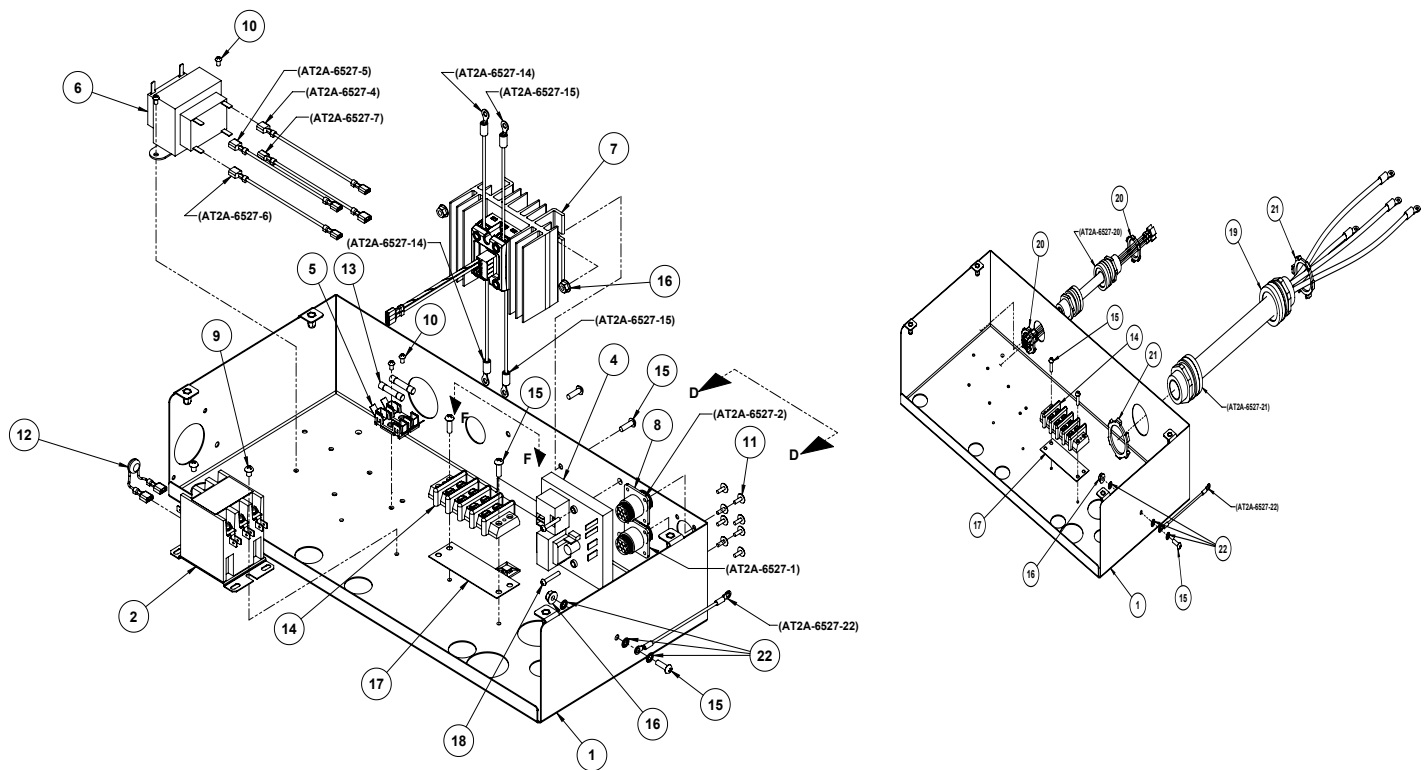

ITEM #	PART NUMBER	DESCRIPTION
#1	AT2A-6560-X	CONTROL PANEL SUBASSY*
#2	AT0E-1587-6	3 POLE CONTACTOR
#3	AT0H-2887-1	CABLE TIE MOUNT
#4	AT0E-3880-2	HIGH LIMIT CONTROLLER
#5	AT0E-2708-1	3AG OMNI-BLOK FUSE BLOCK 2 POS
#6	AT0E-2662-7	TRANSFORMER
#7	AT0A-6262-1	HEAT SINK SSR ASSEMBLY - DUAL POLE
#7-1	AT0E-6259-1	DUAL POLE SOLID STATE RELAY
#8	AT2A-6527-17	HARNESS ASSEMBLY
#9	AT0F-2755-41020	SCREW, #10-24UNC X 1/4 PHILIPS ROUND HEAD
#10	AT0F-2755-21020	SCREW, #6-32UNC X 1/4 PHILIPS ROUND HEAD
#11	AT0F-2777-31030	SCREW, #8 TYPE AB X 3/8 TRUSS HD
#12	AT0A-2736-8	MOV- TERMINALS ASSEMBLY
#13	AT0E-2731-2	FUSE 1¼ AMP 250V
#14	AT0E-1134-4	4 POSITION TERMINAL BLOCK
#15	AT0F-2755-41050	SCREW, #10-24UNC X 5/8 PHILIPS ROUND HEAD
#16	AT0F-1017-41002	NUT, #10-24UNC HEX SERRATED
#17	AT0E-3025-2	INSULATOR STRIP, 4 POSITION DOUBLE ROW
#18	AT0F-2755-21070	SCREW, #6-32UNC X 7/8 PHILIPS ROUND HEAD
#19	AT2A-6527-23	HARNESS ASSEMBLY
#20	AT0E-2086-2	CORD GRIP LOCKNUT
#21	AT0E-2086-4	CORD GRIP LOCKNUT
#22	AT0F-2666-40000	WASHER, SS #10 INTERNAL TOOTH LOCK

Fig 1.8 Electrical Components

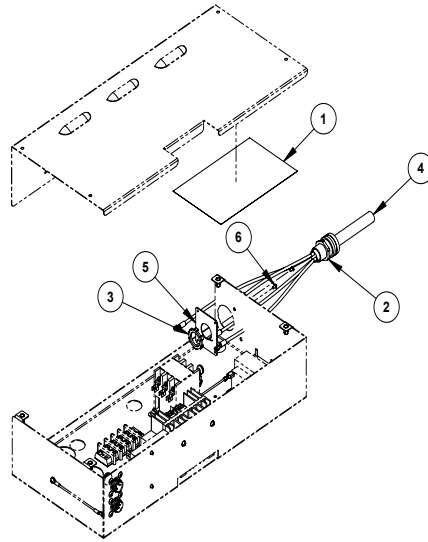

ITEM #	PART NUMBER	DESCRIPTION
#1	AT2L-6418-X	SCHEMATIC LABEL, DROP-IN GRIDDLE*
#2	AT0E-1049-1	STRAIN RELIEF 1 1/4" HUB CABLE RANGE 1.00-1.125
#2-1	AT0E-1049-2	STRAIN RELIEF 1 1/4" HUB CABLE RANGE 1.00-1.125
#3	AT0E-2086-X	CORD GRIP LOCKNUT*
#4	AT0A-2788-X	POWER CABLE ASSY*
#5	AT2M-2768-1	PLATE, ADAPTER
#6	AT0F-2755-21020	SCREW, #6-32UNC X 1/4 PHILIPS ROUND HEAD

*CONTACT ACCUTEMP SERVICE PARTS AT 1-800-480-0415 OR EMAIL parts@accutemp.net



LIFETIMETM
SERVICE & SUPPORT
1-800-480-0415 | service@accutemp.net